

Processed by State of Nebraska Department of Natural Resources Data(Bank) 6/15/2022 4:57:59 PM

Subsection: NWSE Section: 22 Township: 15 Range: 7W

Footage: 2641 feet from the South section line and 2641 feet from the East section line.

Latitude: 41° 15' 24.73" Longitude: -98° 6' 27.51"



Legend

Zooming – 3 options

- Double click on Map to zoom in
- Plus(+) and minus(-) signs in upper left corner of map also zoom in and out. Hover with mouse over area and when pointer disappears, click. Plus is on top and minus is below it.
- Click on map and use mouse wheel to zoom in or out.

Panning – Moving around map

Click on map and hold, drag mouse direction to move map

DISCLAIMER

The well location computations are based on calculated section corners, and not surveyed information or GPS

STATE OF NEBRASKA
DEPARTMENT OF NATURAL RESOURCES
NOTICE OF CHANGE OF OWNERSHIP

Revised 7/2000

0

1. Name, address and telephone number of new owner(s).
Name(s) must be exactly as described on deed or other document transferring ownership of property. If more than one owner, please describe type of ownership, i.e. limited partnership, joint ownership, corporation.

(3066)

Irene Boelts
1503 12th Avenue
Central City, NE

Zip Code 68826 Telephone No. (308) 946-2644

FOR DEPARTMENT USE ONLY

Surface Water Appropriation(s)

Changed: 1/28/02

Ground Water Well Registration(s)

Changed/Updated:

G-033 10/22/01

Central Platte NRD

2. All correspondence is to be mailed to:

Zip Code _____ Telephone No. () _____

3. Legal description of property owned using 40-acre legal subdivisions. This description may also be provided by attaching a document transferring ownership or a tax record. The information must be complete. An incomplete form will be returned for correction. If applicable, please list lot, block and/or street address.

4. This change is filed concerning the following:

a. List surface water appropriation numbers:

b. List ground water well registration numbers:

G-033642

5. The above information is true and accurate to the best of my knowledge.

Date

12-09-02

Signature of new land owner or agent

Irene A. Boelts

Return to:

State of Nebraska
Department of Natural Resources
301 Centennial Mall South
P.O. Box 94676
Lincoln, Nebraska 68509-4676
Phone (402) 471-2363

RECEIVED

RECEIVED

DEC 11 2002 DEC 02 2002

DEPARTMENT OF NATURAL RESOURCES
printed on recycled paper

January 13, 1971

Department of Water Resources

Don S. Jones Jr. Director

Lincoln, Nebraska

Attention Mrs Helma Pangle

Dear Mrs Pangle;

I will try and straighten out my
mistake in filling out the registration
papers for well R-33642. Receipt # 30299

Section 22 - 15 - 7

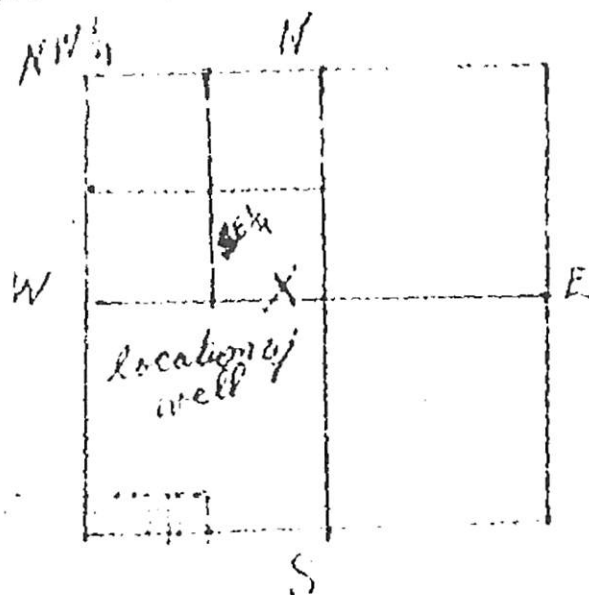

The reason for delay in answering was
due to the fact I was in the hospital.

I am sorry for causing you this
trouble.

Sincerely
Don S. Jones Jr.

Registration No. G-33642 County of Merrick Date Filed November 12, 1970

STATE OF NEBRASKA
IRRIGATION WELL REGISTRATION

I, Dwight Boelts of 1503-12 Ave Central City
(Name of Person registering well) (Postoffice Address)

County of Merrick State of Nebraska, being first duly sworn upon my oath say:

1st. That the name of the owner of the land upon which the irrigation well is located is Dwight Boelts, of 1503-12 Ave Street, Central City County of Merrick
(City or Village)
State of Nebraska

2nd. That the irrigation well is located on the SE Quarter of the NW Quarter of Section 22
Township 15, Range 7 of the Sixth P. M., Merrick County, and is 16
feet from the South line and 375 feet from the East line of said tract.

3rd. That the well was installed with the intention of irrigating all or parts of the following described
land: NW 4 - 22 - 15 - 7
(Give Quarter, Section, Township and Range)

amounting in all to approximately 160 acres.

(If installation consists of a battery of wells with one outlet, give details on a sheet to be attached hereto.)

4th. That the capacity of said well under normal operating conditions is 400 gallons per minute.

5th. That the depth of the well is 68 feet, measured from the surface of the ground.

6th. That the inside diameter of the casing is 17 inches.

7th. That the static water level in the well is 18 feet below ground surface.

8th. That the depth to water under normal pumping conditions is 45 feet below ground
(Pumping Level)
surface.

9th. That the diameter of the pump column is 6 inches. That the diameter of the 4
(Give number of bowls)
bowl or bowls is 10 inches.

10th. That the type and size of impeller is as follows:

Western Sound Roller

11th. That the well was completed on or about the 8 day of July, 1969.

12th. That attached hereto are three copies of the log of the well certified to by the driller of the well.

13th. That the driller of this well is Le Roy Seim, whose address is

Rural Route Chapman Nebraska

14th. That the name of the tenant or operator, if other than the owner, is David Backs

whose address is Rural Route Chickasaw Nebraska

15th. That the relation which the subscriber to this instrument bears to said registrant is that of

Dwight Backs Owner

(State whether owner, tenant or agent for land on which well is located)

and that he is authorized to sign this instrument in behalf of the interest affected.

Signed: Dwight Backs

Dated: November 8, 1970

This drawing represents one Section
Mark with an "X" the location of the irrigation well

Section No. 22

Township 15

Range 7

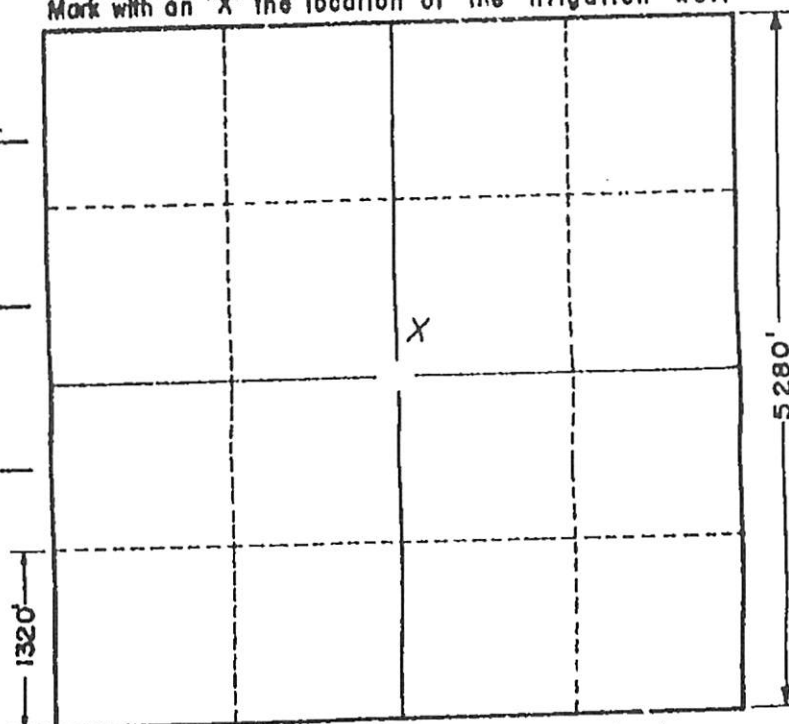

Each small subdivision is a 40-acre tract.

State of Nebraska

Department of Water Resources

ss.

This instrument was filed for record at 8:15 o'clock A.M., on the 12th day of Nov. 1970.

Don S. Jones
Director of Water Resources

Revised April 1, 1968
Lrr. 87-3

Registration No. G-33642 County of Merrick Date Filed Nov. 12, 1970

STATE OF NEBRASKA
CERTIFICATE OF WELL DRILLER

I, Lee Roy Seaman of Chapman
(Name of Driller) (Postoffice Address)

County of Merrick State of Nebr, do hereby certify that:

1. I am the driller of a well located on the NW Quarter, Section No. 22
Township 15 North, Range 7, owned by Douglass Boelts
whose postoffice address is Central City State of Nebr

2. That the drilling was begun on the 18 day of June, 1969, and completed on
the 18 day of June, 1969.

3. That the well is cased and screened in the following manner: 1 - 40 - plain
(Give kind of casing, lengths and position of plain and
40 - 68 - screened
screen casing, weight of metallic casing, etc.)

4. That the diameter of drilled hole is 36 inches.

5. That Reverse Rotary type of drilling machinery was used.

6. That the drilled hole is/is not sealed, as follows: -

7. That the following is an accurate log of the depth, thickness and character of the different strata penetrated, and the location of water-bearing strata:

DEPTH IN FEET FROM	TO	MATERIAL DRILLED
<u>1</u>	<u>30</u>	<u>Topsoil & Sand</u>
<u>30</u>	<u>38</u>	<u>Hard sand</u>
<u>38</u>	<u>45</u>	<u>red gravel</u>
<u>45</u>	<u>65</u>	<u>gravel</u>
<u>65</u>	<u>68</u>	<u>clay</u>

Date Signed Oct 10 - 1970

Lee Roy Seaman
Driller

(If more space is required please use reverse side of this page.)